

# DESIGN INTENT DRAWING

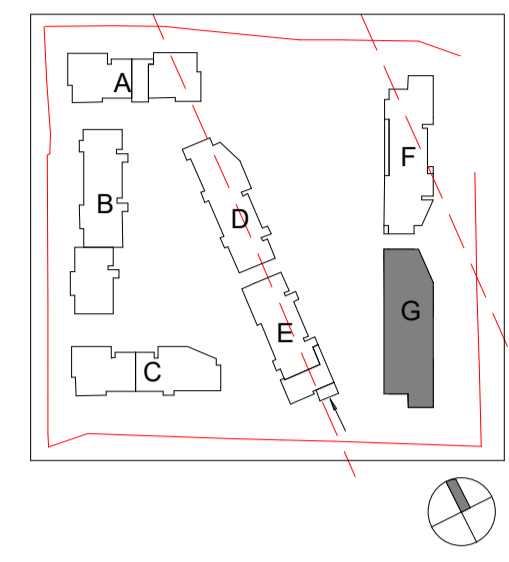

- Room Legend**
- EH/C Entrance Hall / Corridor
  - KLD Kitchen / Living / Dining Room
  - BD1 Bedroom 1
  - BD2 Bedroom 2
  - BD3 Bedroom 3
  - BR Bathroom
  - BR/ES Bathroom / En Suite
  - ES En Suite
  - ST Store
  - POS Private Open Space
  
  - ER Electrical Riser
  - MR Mechanical Riser
  - MSV Mechanical Smoke Vent

**1** GA - Fifth Floor Plan  
1: 100

Rev	Description	Date	Dr by	App by
Project Stage				

## PLANNING

Client:  
Eastwise Construction Swords Limited

Project:  
Hartfield Place  
Swords Road, Whitehall, Dublin 9  
D09 C7F8

Drawing Title:  
BLOCK G - Fifth Floor GA - 472 Units

Drawn	Checked	Paper Size	Scale	Date
DP	CM	A1	1: 100 @A1	Mar. 2022

Project No.	Drawing No.	Classification	Revision
HARTPL	072505		

File Name:  
HARTPL-CWO-BG-05-DR-A-072505

Status:  
S2-Suitable For Information

